

DUPLICITY S

In Ground - Drive Over

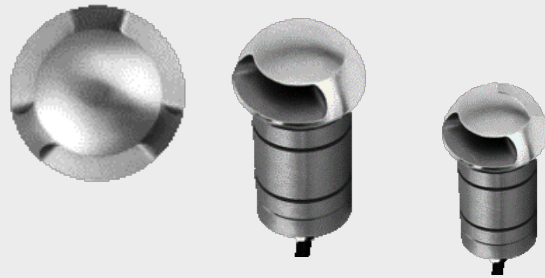

DUPLICITY S is our 3 LED inground which tnatropmifillfillsrequirements: Small dimensions and powerful light effect.

With a small diameter of 50mm, dimension, Axis recessed inground allows to create powerful and pure light effect. It can be used as a single point of light, thanks to its dimensions. Suitable for installation on roof for outdoor areas, in the drive-over use. Installation in concrete with a recessed box.

Luminaire comes with 2 sides cable as standard.

Key Advantages

- Drive over
- High thermal performance
- High corrosion resistance
- High IP protection
- Excellent light output
- High Ambient temperature
- Easy installation

Characteristics

Aluminum injection Die Cast Body
Electrostatic Powder Paint
Optional RAL Colors
Extra Clear 5mm Tempered Glass
Aluminium PCB
LED with Life Span > 100.000 Hours
CCT tolerance within a 3 step MacAdams ellipse
Corrosion Protection
5 Years Warranty
Marine Coating (Optional)
ENEC Certified Driver

Applications



